

Denotes: Hand measured dimensions, obtained by the engineer on site & are not the product of a specialist Land surveyor. Once the existing building has been demolished, the builder should therefore reconfirm the site dimensions & report any discrepancies before proceeding to setting out the building to the proposed width (7955) & depth (10220).

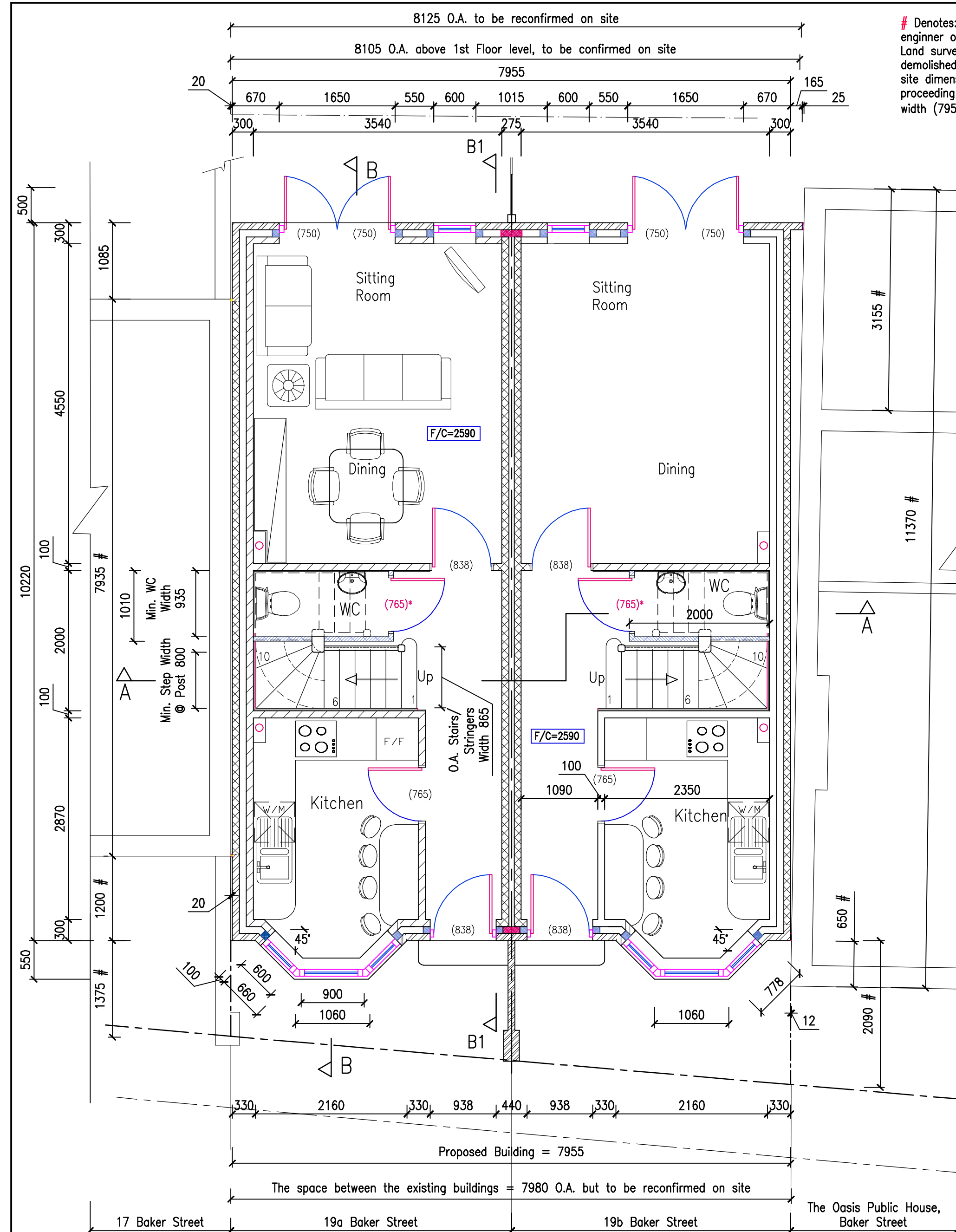

PROPOSED GROUND FLOOR PLAN scale 1:50

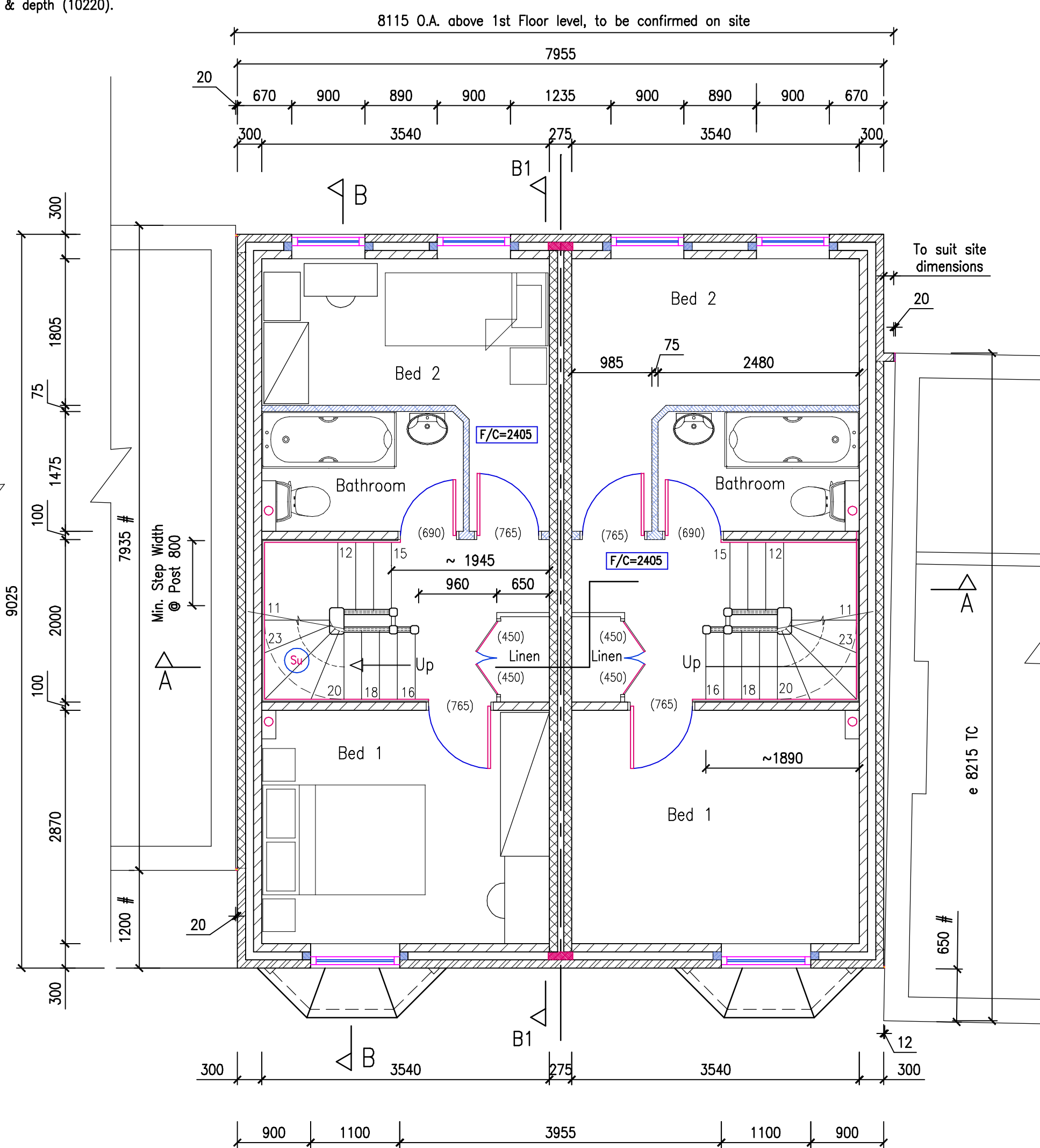

PROPOSED FIRST FLOOR PLAN scale 1:50

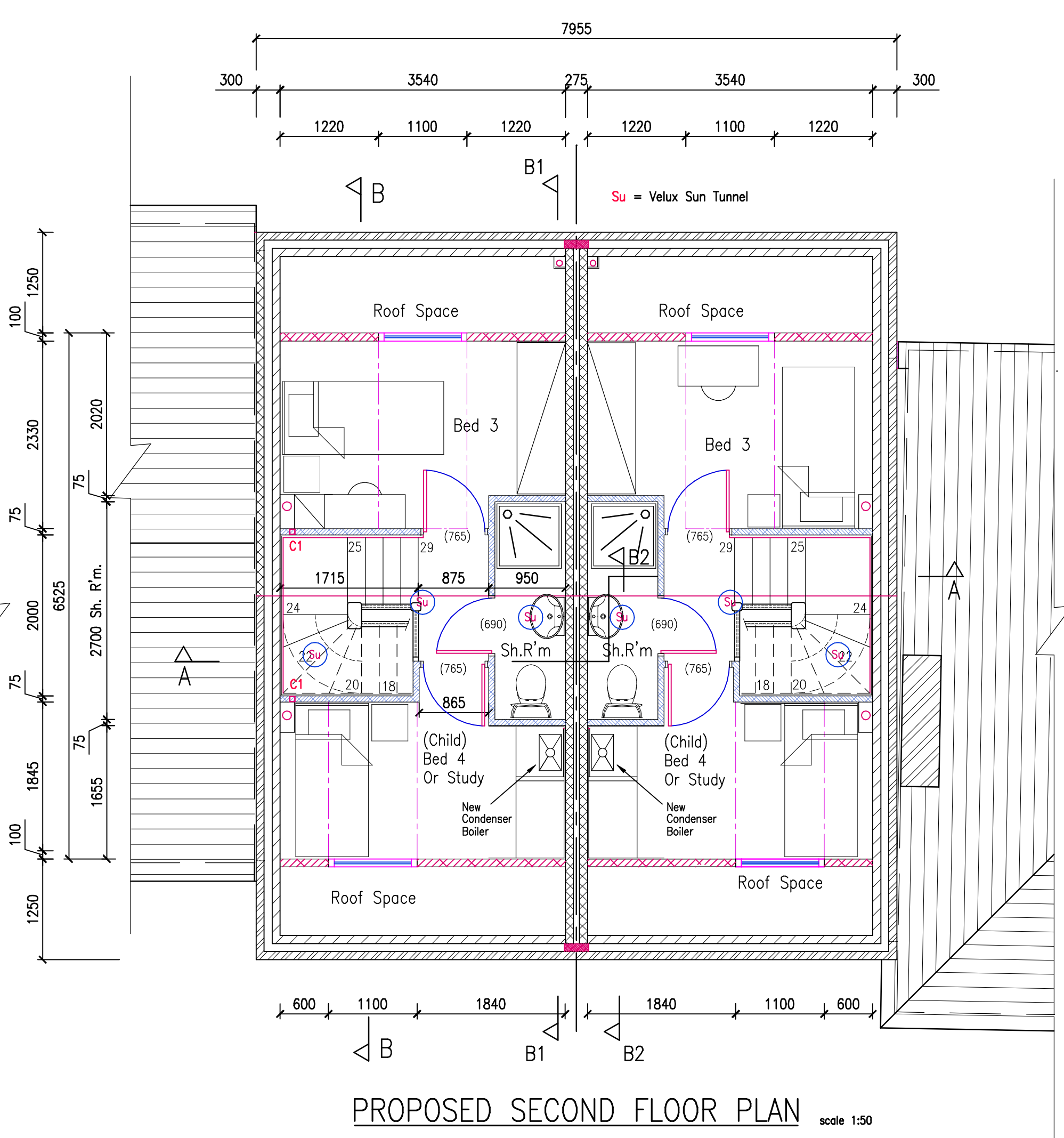

PROPOSED SECOND FLOOR PLAN scale 1:50

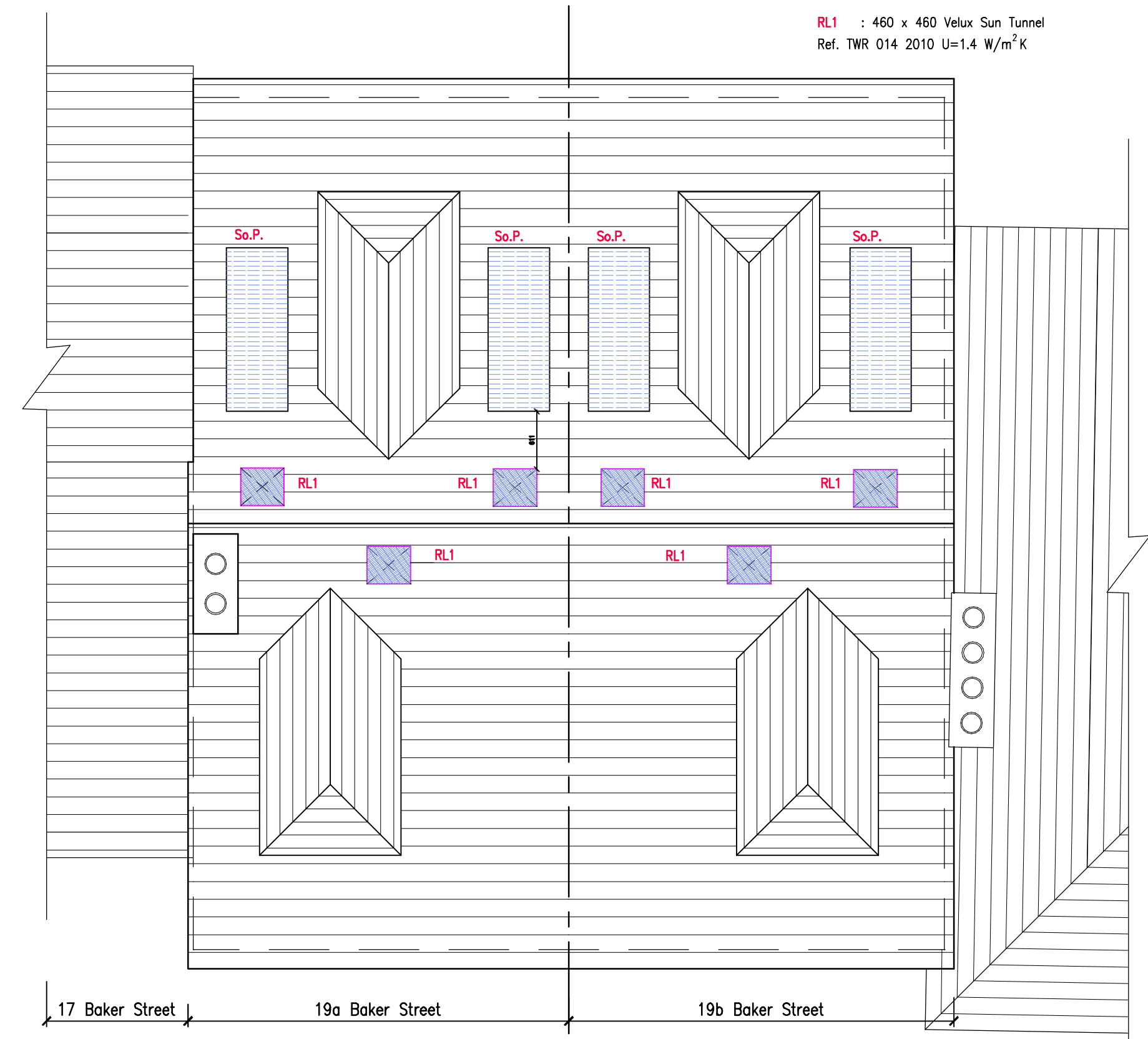

PROPOSED ROOF PLAN scale 1:50

RL1 : 460 x 460 Velux Sun Tunnel
Ref. TWR 014 2010 U=1.4 W/m²K

So.P : Solar Panels to specialist suppliers design, details & specifications.

PRELIMINARY

No.	Description	By	Date
D	Air Source Pump removed. Gas Boiler Added. Floor Plans updated. Solar Panels added to the roof plan.	JBS	09 May 2010
C	The drawing retitled. Added: Roof lights, Sun tunnels & C1 posts.	JBS	Apr. 2010
B	Revised internal layout. Enlarged 2nd floors towards front & rear. Added 1) Heat Source Pump installation. 2) False Chimney stack. 3) Roof Plan	JBS	Mar. 2010
A	Complete revision of the building area to suit site measurements & adjoining properties. Amended the stairs & adjusted the habitable rooms, bathrooms & WC etc. to suit the revised building.	JBS	Feb. 2010

J.B. SLEIMAN Bsc. Honours C. Eng. M.I.Struct.E.
CONSULTING CIVIL & STRUCTURAL ENGINEER
 8 CASTLE ROAD, WINTON, BOURNEMOUTH BH9 1PJ
 TEL / FAX: 01202 523875 MOBILE: 07958 611445

Project: **PROPOSED NEW HOUSES @ 19a-19b BAKER STREET READING RG1 7XT**

Title: **GENERAL ARRANGEMENT LAYOUT SHOWING GROUND, FIRST & SECOND FLOOR PLANS**

DRAWN	JBS	Drg. No.	2010/02/01D
DATE	Feb. 2010		
SCALE	1:50		